

## Quadristar 900 TOS 40° P



### Electrical Specifications

<b>Voltage</b>	8V (0%) - 13V (100%)
<b>Connection</b>	Triple O-ring Sealing Plug
<b>Power</b>	14W @ full power
<b>Emitter</b>	4 x Cree XP-G
<b>Driver</b>	Microprocessor controlled PWM 0 - 100% linear dimming with GFI Dive Light Controller Thermal protection

### Material Specifications

<b>Body Treatment</b>	Aluminum AA6023 AlMgSiSnBi Black Hard anodization MIL-A-8625 Type III with Surlon MIL-A-63576 coating
<b>Optics</b>	High efficiency Polycarbonate
<b>Front Lens</b>	10mm BK7 glass
<b>Depth rating</b>	250 m, 26 BAR
<b>Weight</b>	190g

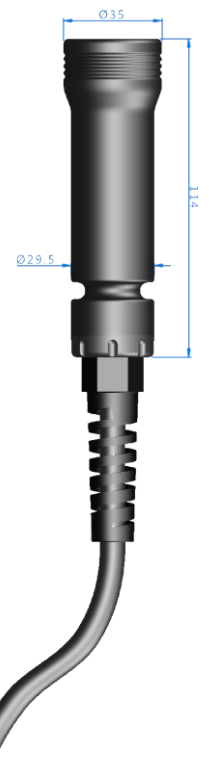

## Optical Specifications

<b>Luminous Flux</b>	900 lumen @ 12V
<b>Illuminance</b>	1550 lux @ 1m
<b>Beam Angle</b>	40°
<b>Color</b>	5200K

### Beamshot

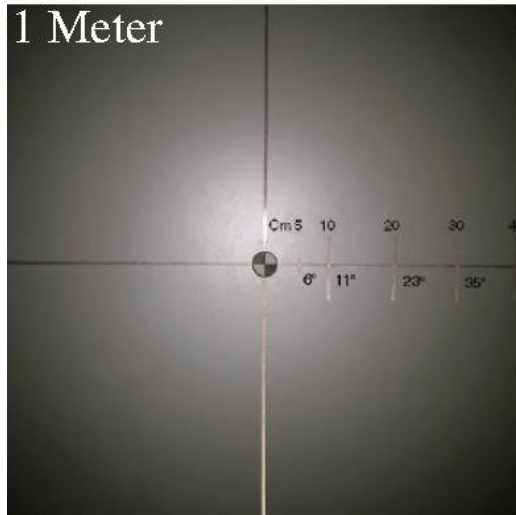

### Spectro Metric Analysis

